



# THE RANDOLPH FOUNDATION ANNUAL REPORT

December 2018

Dear Randolph Friends and Family,

Welcome to the Randolph Foundation's annual report for July 2017 through June 2018, along with a special section on the summer's successful Mt. Crescent Land Protection Campaign! We distributed the Foundation's preliminary report at our annual meeting in August, **but waited until now to send out the final version so we could share the impressive results of the Mt. Crescent land community fundraising effort with you (see pages 10-11).**

First, some gratitude. It's a tremendous privilege for me to be serving as the Foundation's current president. I have the opportunity to witness first-hand the hard work and dedication of each of our board members, as well as the incredible generosity and communal spirit of the entire Randolph community. We are all bound together in celebration of a special place and its remarkable history — what a blessing!

Inside you will find updates on all of the Foundation's activities as well as **a heart-felt thank you to the donors who contributed to the Randolph Foundation's 2017-18 annual fund (see pages 8-9).** These donations support the Foundation's charge of maintaining and improving the Ravine House Site area, awarding local grants, administering educational scholarships, providing Lifeline services for our residents, producing community publications, and planning special events that bring our community together.

**If you are thinking of making a year-end contribution to the Randolph Foundation, we encourage you to do so — a donation envelope is enclosed!**

A few notes for next year:

- I want to thank Clover Koopman for her service as editor of The Randolph Weekly. She did a terrific job collecting, producing, and distributing the news on behalf of our community, and we are grateful to her. We are now seeking a new editor — please be in touch if you are interested in the role (which includes a stipend).
- The Story Slam, brought to you by the Randolph Foundation and the Randolph Church, will be held on Saturday, August 3, 2019 at the Randolph Church at 4 PM. If you'd like to reserve a story-telling spot, contact me at [seg@mit.edu](mailto:seg@mit.edu) or Bill Minifie at [whminifie@gmail.com](mailto:whminifie@gmail.com).
- The Randolph Foundation Annual meeting will be held on Friday, August 16, 2019 at the Town Hall at 4 PM.

With gratitude,

Sarah Eusden Gallop, President

## **The Mission of the Randolph Foundation**

The Randolph Foundation was created, and is sustained, by the residents and friends of Randolph, New Hampshire. The Foundation supports the needs of Randolph and its neighboring towns in a variety of areas including conservation, communication, education, recreation, town history, leadership, health and welfare, and other important issues as determined by the Board of Directors and the Randolph community.

## **Thanks to the 2017-2018 Board of Directors**

Sarah Gallop, president, Peter Rowan, vice-president, Sue Temme, secretary, Angela Brown, treasurer, Bruce Kirmmse, Ben Phinney, Phil Guiser, Guy Stever, and Mark Santos

This group dedicated itself to every aspect of the Foundation's mission. A special thanks goes out to retiring board members Bruce Kirmmse and Peter Rowan who oversaw major projects and critical work at the Ravine House Site area, and Sue Temme who served as our devoted Secretary. We honored them at the Annual Meeting and are grateful for their contributions.

## **Randolph Foundation Board 2018-2019**

### Officers

Sarah Gallop (2021), President  
Phil Guiser (2022), Vice President  
Angela Brown (2021), Treasurer  
Gaye Ruble (2021), Secretary

### Board Members

Kelly Eggleston (2023)  
Gary Newfield (2023)  
Ben Phinney (2019)  
Mark Santos (2022)  
Guy Stever (2022)

### Emeritus Board Members

Bruce Kirmmse  
Peter Rowan  
Sue Temme

## New Board Members

Kelly Eggleston grew up just over the hill in Gorham. However, she has always had a close connection to Randolph, as she spent a great deal of time throughout her childhood at her grandparents, Auvie and Judy Kenison's. Some of her earliest memories of Randolph include watching the helicopter fly supplies up to the huts, swimming in her grandparents' pond, and squashing "potato bugs" (yuck!). Kelly lives with her husband Joe, in the home of what many likely remember as being occupied by Herbert and Helen Abbott. Kelly officially moved to Randolph in February 2008 and graduated from the University of Maine - Farmington (UMF) summa cum laude with a B.A. in Geography in May 2008.

While at UMF pursuing her degree, Kelly dabbled in environmental science and geographic information systems (GIS) courses and enjoyed both immensely. Shortly after graduation, Kelly applied for an internship with the Natural Resources Conservation Service (NRCS) and began her adventure with NRCS in October 2008. In that role, she put her mapping skills to good use. Now, almost 10 years later, she serves as the District Conservationist for Coos County. This is a position she was hired for in March 2016. When not working, Kelly enjoys spending time with family, gardening, hiking, exploring all that northern New England has to offer, and occasionally traveling when time allows.

Gary Newfield was born in Taunton, Massachusetts and graduated from UNH with a degree in Recreation and Park management in 1977. After his junior year at UNH he worked a summer as a back-country ranger with the Androscoggin Ranger District. This led to 4 more summers of the same. In between he taught cross-country skiing during the winters. In 1980, he began a 5-year hitch with the AMC on their construction crew. After his time there, he spent 10 years off and on working/teaching for Hurricane Island Outward Bound school based in Maine. In 1995, he became a registered nurse, settled down a bit, and today works as an RN in the emergency room at Dartmouth Hitchcock Hospital.

Gaye Ruble was born in Michigan, but grew up primarily in Georgia. She completed her undergraduate studies and obtained her DVM degree from the University of Georgia College of Veterinary Medicine. She married a classmate (David) who joined the US Army shortly after graduation, and thus began several years of relocation and multiple private practice jobs. After five years, she decided to continue her education and enrolled in a post-doctoral fellowship program in Laboratory Animal Medicine at Johns Hopkins University.

After completing the program and obtaining a Master's in Public Health, she took the "if you can't beat 'em, join 'em" approach and joined the Army as well. She supported biomedical research at several laboratories in the Washington DC area, with a final assignment in Bangkok, Thailand. In 2001, David retired from the military, she resigned her commission, and they moved to New Jersey, where she spent 15 years supporting drug development at a pharmaceutical company. In 2010, while vacationing in Jackson, NH, they visited friends in Randolph and fell in love with the area. They bought their retirement home and moved here permanently in December 2013. She is now retired and enjoys spending her free time hiking with her spouse and two dogs, pattering in her garden, and cooking.

**Celebration 2024 (Co-Chairs Guy Stever and Sarah Gallop)**

The Town of Randolph will mark its 200<sup>th</sup> birthday in 2024. The Foundation has agreed to take the lead in planning a celebration fitting for the occasion. A kick-off Celebration 2024 meeting was held on Saturday August 11, where a preliminary list of projects and events were generated. A celebration framework is in the process of being developed.

Meanwhile, the 2<sup>nd</sup> Randolph Story Slam, co-sponsored by the Randolph Foundation and the Randolph Church, took place on Saturday, August 4. Nearly 80 people attended to hear 19 stories which are now posted on the Randolph Foundation’s YouTube site. These stories are being collected as part of the bicentennial initiative.

**Grants (Chair Mark Santos)**

The Foundation awarded seven grants totaling \$6,865. The majority of the funds awarded went to programs associated with local schools or to individual educational endeavors.

Ed Fenn school field trip	\$1,815
GMHS Junior Welders	\$1,000
Flight School	\$1,850
Fearlessly Girl.	\$1,000
Preschool Music	\$ 400
Woodspringstock	\$ 600
Maria Neal workshop	<u>\$ 200</u>
	\$6,865

**Ravine House Site/Durand Lake (Chair Phil Guiser, Bruce Kirmmse, Peter Rowan)**

The pool and lake area seem to be in fine shape. Members of the Foundation and public toured the Lake’s dam with Kelly Eggleston (our new Board member) and Ally Hook, both of the USDA Natural Resources Conservation Service. Brendan Prusik of the UNH Extension Service led us on an inspection of the fields and woods around the lake/pool area. The findings in both cases are that the area seems to be well managed. There were some suggestions as to things to keep our eyes on and improvements to consider but no areas of immediate concern were identified. The Foundation made some landscaping improvements to the pool and lake area and oversaw the annual mowing.

Most noteworthy was the Town providing the resources to open the bathhouse for use during the swimming season. The pool area is being enjoyed by more people than any summer in recent history.

The volunteers who keep this area looking fine and functioning are too numerous to mention. But special thanks goes to Alison and Dave Tomlinson for overseeing and maintaining the tennis court, Jean Malick and Marcia Lee for keeping the Ravine House Site gardens looking beautiful, the RMC for maintaining the trails and bog bridges around the Lake area and Edith Tucker for sharing advice and historical perspective. Also, appreciation

goes to those who help control the beavers' impact, pick up any trash left by others, brush the paths, and just do whatever else needs to be done.

### **Scholarships (Chair Angela Brown)**

Since 1963, the Randolph Foundation has awarded scholarships to eligible Randolph residents to pursue their studies at the post-secondary level. The Foundation recognizes any courses at an accredited institution that provides undergraduate and/or graduate work. Undergraduate students who are officially enrolled in a course of study, upon submitting all needed application forms, will receive a base scholarship of \$1,700 annually, based on a 2-semester academic year full-time course of undergraduate study, not to exceed \$6,800. Beginning at the second term of the first year of study, an undergraduate whose GPA (grade point average) is 3.2 or higher for that semester will receive \$1,000 to be used for the following semester, based on a 2-semester academic year. Graduate students receive a flat scholarship of \$1,500 annually for a full-time course of graduate study not to exceed three (3) years.

During the past school year, the Randolph Foundation provided scholarships to the following undergraduate students:

Esty Oelofse, UNH (graduated 2018)

Sam Ouellette, UNH (graduated 2018)

Philip Rousseau, WMCC (graduated 2018)

Jana Oelofse, SNHU

Autumn Brown, BYU-Provo

Kayla Demers, a graduate student the Tuck School of Dartmouth College.

If you are interested in pursuing further education, please review the scholarship guidelines on our website [www.randolphfoundationnh.org](http://www.randolphfoundationnh.org) to determine your eligibility. As always, we are truly thankful for your donations that allow us to continue to fund undergraduate and graduate scholarships for our Randolph students.

### **Finance (Chair Ben Phinney)**

The value of the Foundation's investments at fiscal year ended June 30, 2018 were \$686,869 compared to \$716,252 at the same date in 2017. These figures are for the Foundation's assets invested with Janney Montgomery Scott and do not include receivables or cash on hand at Northway Bank. During the year, the Foundation transferred \$20,000 to the checking account at Northway Bank to partially fund the operating budget. Additionally, \$53,000 was withdrawn in April 2018 to fund the temporary purchase of real estate near the Mt. Crescent Trailhead. Proceeds from the Mt. Crescent Land Protection Campaign will be used to repay this.

The investment return for the portfolio for the fiscal year was 4.26% which compares with a blended return of 4.70%. Asset allocations at the fiscal year end were 64% equities and 36% fixed income securities and cash equivalents. Members of the Finance Committee

include Sarah Gallop, Phil Guiser, Angela Brown, and Ben Phinney. We continue to appreciate the excellent advice and service of Geoff Beringer, who manages the account at Janney Montgomery and Scott.

### **Lifeline (Chair Heather Wiley)**

Lifeline is a 24/7 service provided by New England Emergency Response System (NEERS) to provide both year-round and summer residents with a lightweight, waterproof button for emergency use. When the button is pushed, whether in your home or on your property, NEERS will call the client immediately and then call the designated emergency contact person or 911 if needed.

The Foundation provided eight residents with support this year. Please note that this safety device is now provided at no cost to the resident – the Randolph Foundation pays half the monthly fee and the town of Randolph pays the other half. Clients do not have to have a landline to avail of this service – it can also be hooked up to a cell phone.

The Foundation had budgeted significantly more for Lifeline this fiscal year. Please encourage your elderly or disabled friends and neighbors to avail of this excellent service! For more information and to sign up please contact Heather Wiley at 466-5179 or [rcotnoir@ne.rr.com](mailto:rcotnoir@ne.rr.com).

### **Communications (Chair Sarah Gallop)**

We are indebted to the editors of the Foundation's various publications (the *Blizzard*, Linda Dupont, the *Mountain View*, Dede Aube, and the *Weekly*, Clover Koopman). These publications keep our community informed of Randolph happenings and closely connect us through stories about our families, descriptions of projects that we're working on, photographs of our adventures, and summaries of important issues that impact the Randolph area. The Foundation's website and YouTube channel are updated as needed.

The *Mountain View* is distributed to approximately 700 households four times a year. Editor Dede Aube welcomes articles and photographs related to the interests and activities of our community. She can be reached at: [dedeaube@gmail.com](mailto:dedeaube@gmail.com).

The Monthly *Blizzard* is mailed to approximately 200 residents from September to June. Linda Dupont can be reached at [linda.dupont90@yahoo.com](mailto:linda.dupont90@yahoo.com) or 603-723-3907.

The *Randolph Weekly* is published and circulated each Friday during the months of July and August. Many thanks to Clover Koopman who ably served as Editor for the past two years. She had decided to step down, and we are now seeking a new Editor.

## Treasurer's Report (Treasurer Angela Brown)

### Randolph Foundation Budget to Actual FY 2018

	Budget FY18	Revised FY18	YTD Total
<b>Incoming Funds</b>			
Donations	25,000.00	\$ 20,000.00	\$ 19,384.50
Interest -- Northway	0.00		\$ 3.37
Royalty	0.00		\$ 26.02
Janney Account	33,350.00	\$ 28,000.00	\$ 28,000.00
Other (paypal)	0.00		\$ 2,274.17
<b>Total Incoming Funds</b>	<b>\$58,350.00</b>	<b>\$ 48,000.00</b>	<b>\$ 49,688.06</b>

### Expenses

Admin - GF	6,500.00	\$ 5,000.00	\$ 5,512.57
Durand/Ravine*	4,000.00	\$ 5,000.00	\$ 4,738.09
Grants	7,000.00	\$ 7,000.00	\$ 6,865.00
Lifeline	2,250.00	\$ 2,000.00	\$ 1,818.50
Website	1,000.00	\$ 1,000.00	\$ 717.50
Scholarships	20,100.00	\$ 12,000.00	\$ 11,400.00
Blizzard	2,500.00	\$ 2,000.00	\$ 2,165.00
MountainView	9,000.00	\$ 8,000.00	\$ 8,938.99
Weekly	1,000.00	\$ 1,000.00	\$ 828.50
Celebration 2024**	5,000.00	\$ 5,000.00	\$ 577.85
<b>Total Expenses</b>	<b>\$58,350.00</b>	<b>\$48,000.00</b>	<b>\$ 43,562.00</b>

### Randolph Foundation Budget FY 2019

#### Budget

#### Incoming Funds

Donations	25,000.00
Interest -- Northway	0.00
Royalty	0.00
Janney Account	23,900.00
Other (paypal)	0.00
<b>Total Incoming Funds</b>	<b>\$48,900.00</b>

#### Expenses

Admin - GF	7,000.00
Durand/Ravine*	5,000.00
Grants	7,000.00
Lifeline	2,000.00
Website	1,000.00
Scholarships	10,000.00
Blizzard	2,500.00
MountainView	9,000.00
Weekly	1,000.00
Celebration 2024**	4,400.00
<b>Total Expenses</b>	<b>\$48,900.00</b>

### Donations to the Randolph Foundation (Secretary Sue Temme)

On behalf of the Randolph Foundation, we would like to thank our 108 generous donors during the period July 1, 2017 through June 30, 2018. These donations have allowed us to not only continue our mission, but also to grow as a community.

Alden, John	Goetze, Rolf and Julie
Alexander, Heywood and Bea	Gourley, Carol
Bellisio, Jules	Guiser, Philip
Beringer, Marie	Hartman, Steve and Wendy Walsh
Berry, John and Mary	Hawkins, Chris
Bishop, Barbara and John	Henderson, Reed and Carol
Bisshop, Fred and Susan Ellis	Horton, Alan
Borden, Norma and Allan	Hunt, Lynn
Brockett, Laura	Johnson, Martin and Elizabeth
Brown, Charles and Angela	Kelley, BJ and Lisa
Brown, John and Mary	Kellner, Wayne and Ann
Bryan, Caesar and Gail	Kenison, Auvern and Judy
Bush, William and Jacqueline	Landaeta, David
Cameron, Bruce and Hazel	Maddock, Steve and Margot
Canaday, John and Cynthia	Malick, Jean
Choukas-Bradley, Jim and Melanie	Martinson, Jon
Cormier, Paul and Michele	May, Laura and Ted
Crary, Alexander	Mayer, Doug
Crary, Jonathan	McDowell, John and Cathy
Crary, Sarah	Meiklejohn, Brad
Demers, Ernest and Denise	Meiklejohn, Randy and Diane Sokal
Doan, Marjorie	Meiklejohn, Scott
Doyle, Dick and Caroline	Minifie, Charles
Dunham, George and Renee	Minifie, William
Dunseath, Tom and Diana	Morneweck, Sam and Leslie
Eisenberg, Ben and Arlene	Mudge, John
Eisenbud, Dan and Marina	Nelson, Denise and John Kalagher
Erwin, Bob	Newfield, Gary
Eusden, Alan and Lynn	Ogilby, John and Katrina
Farnham, Lynn	Parlett, William
Ferreira, Regina and Tami Hartley	Penney, Mary Ellen
Fitzpatrick, Shaun	Person, John
Forsyth, Ann	Pettigrew, Ralph
Glines, Sara and Greg	Pfeffer Family Trust



Phinney, Ben and Barbara  
 Phinney, Joanna  
 Purcell, Dennis and Rose  
 Rising, Joan  
 Rising, Bill and Mary  
 Rowan, Peter and June Hammond Rowan  
 Roy, David and Doreen  
 Saunders, Katherine  
 Shannon, Jim and Silvia  
 Skofield, Jane  
 Smith, Richard and Kim  
 Snider, Brenda and Martin  
 Snyder-Grant, Jim  
 Stever, Guy and Barbara  
 Teczar, Steven and Elizabeth  
 Tomlinson, Alison and David  
 Tremblay, John and Kathleen  
 Upton, Richard  
 Vandemoortele, Gary and Chris  
 Vervoort, Edward  
 Virk, Preetinder  
 Wang, Sarah  
 Wemyss, Howie  
 Wenk Stone Family Fund  
 Wiley, Heather and Ray Cotnoir  
 Wiley, William  
 Willcox, David and Doris  
 Williams, Diana  
 Winchell, David and Charlotte  
 Wysession, Barbara

**In Memory of Kenneth, Terry and Ryan  
 Corrigan**  
 Jeannette Corrigan

**In Memory of Rupert and Jeannie  
 Corrigan**  
 Rupert and Wilma Corrigan

**In Memory of Henry Cutter**  
 Victoria Fisher

**In Memory of Peggy Horton Grant**  
 Alan and Joan Horton

**In Memory of Harriet Kruszyna**  
 Peter Rowan and June Hammond Rowan

**In Memory of Meg Meiklejohn**  
 Peter Rowan and June Hammond Rowan

**In Memory of Alice Horton Tibbetts**  
 Alan and Joan Horton  
 Anne Wells

**In Memory of Frank Treddinick**  
 Fred and Karen Burley  
 P.K. and L.B. Davis

**In Honor of Nancy Davis**  
 Edward and Constance Blanchard

**In Honor of Vicky Hutchens**  
 Alex and John Treddinick

## Mt. Crescent Land Protection Campaign

In early 2018, the Randolph Foundation was presented with an opportunity to play a leadership role in protecting land in the Mt. Crescent environs. In keeping with its mission of promoting conservation and recreation, the Foundation teamed up with the Randolph Mountain Club to launch the Mt. Crescent Land Protection Campaign.

The Campaign focused on raising \$52,500 to purchase a sixteen-acre parcel of land at the foot of Mt. Crescent. That parcel is adjacent to the Community Forest Trailhead and is traversed by several RMC paths (see light green area in map below). Working with the Town, the goal is to add this land to the Randolph Community Forest, which will be a major step forward in protecting the area from development. A further opportunity to protect the Mt. Crescent area presented itself at an abutting parcel (see striped area in map). The campaign committee worked with the owner to negotiate a \$26,000 purchase of a conservation easement on that land. This means that access to the three RMC trails and the Community Forest Trailhead on that parcel will be permanently protected from incompatible uses and/or future development.

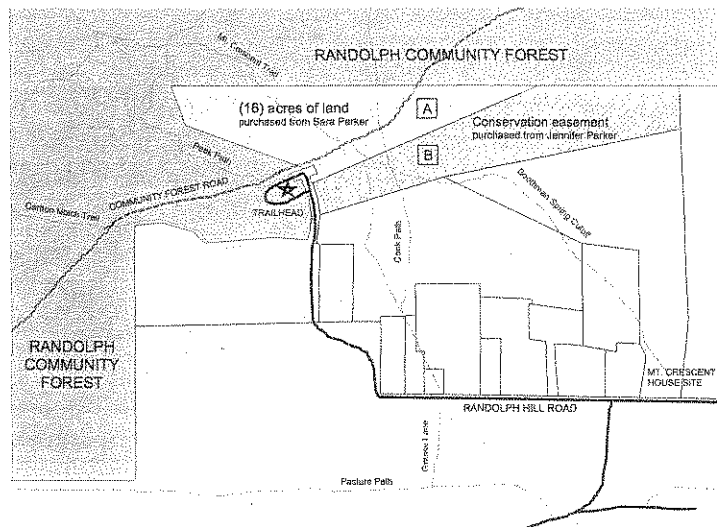

Thanks to the generosity of 73 individuals and families (see next page), the Foundation raised the \$52,500 and the \$26,000, so that we can implement protections for both parcels of land. The Foundation will be following up with the Town of Randolph and other parties to execute these transactions. We could not have achieved this tremendous community success without each one of you — thank you to the entire Randolph community!

We are indebted to the campaign committee members who devoted themselves to this endeavor — Sarah Eusden Gallop, Sally Boothman Glines, Jamie Maddock, Randy Meiklejohn, Ben Phinney, and John Scarinza — and we thank them for their stewardship and leadership. We would also like to acknowledge the hard work of Randolph Foundation Treasurer Angela Brown and Secretary Sue Temme who together managed the contribution details.

## Mt. Crescent Land Protection Campaign Donors

Alexander, Heywood and Bea	May Family
Arnold, Barbara and Bill	Mayer, Doug
Balph, Martha	McCarron, Frank and Sandra
Beringer, Geoffrey	McDowell, Catherine
Berry, Mary and John	McLaughlin, Eleanor
Bishop, Barbara and John	Minifie, Bill and Kemp
Brockett, Laura	Meiklejohn, Randy and Diane Sokal
Bronnert, Michael	Meiklejohn, Scott
Bryan, Caesar and Gail	Newfield, Gary and Heather
Cairns, Bruce and Donna	Ogilby, Lydia
Choukas-Bradley, Jim and Melanie	Parlett, William
Crary, Alexander	Pettigrew, Ralph and Mechthild
Dempster, Keith and Red	Pfeffer Family Trust
Doyle, Dick and Caroline	Phinney, Ben and Barbara
Dunham, George and Renee	Phinney, Joanna
Erwin, Bob	Phinney, John
Eusden, Alan and Lynn	Phinney, Martha
Eusden, Andrea and Charles Armstrong	Potter, Bob and Roberta Arbree
Evert, Elizabeth Cutter	Randolph Area Opportunity Conservation Fund
Farnham, Lynn	Rising, Bill and Mary
Ferreira, Regina and Tami Hartley	Rounds, Polyxeni and Richard Mitchell
Fleming, Scott and Nanette	Shannon, Jim and Silvia
Forsyth, Anne and David	Smith, Ronald and Kim
Gallop, Sarah Eusden and Andy	Sochard, Al
Glines, Sally and Greg	Tomlinson, Alison and Dave
Grant, Peter	Tucker, Edith
Hauptmann, Erica	Umiker, Ginny Folsom and Rick
Horton Family	Vervoort, Edward
Hudson, Judy and Al	Weatherly, Mark and Danila
Kelley, Katie and Mark	Wells, Anne
Kelley, Lisa and BJ	Wells, Heidi
Kern, Susan and Louis	Wemyss, Howie and Sue
Landaeta, David	Whiston, Lionel and Debra
Lee, Kenneth	Wiley, Constance
Maddock, Margot	Wiley, William
Maddock, Jamie and Sue	Wojcicki, Elizabeth
Malick, Jean	



Photo by Sarah Eusden Gallop

**Ravine House Pool bath house flowers, planted by June Hammond Rowan**

\*\*\*\*\*AUTO\*\*MIXED AADC 010  
280  
Sarah & Andrew Gallop  
25 Grayson Rd  
Winchester MA 01890-1307

NONPROFIT ORG  
U.S. Postage  
PAID  
BERLIN, NH  
PERMIT NO. 42

**Randolph Foundation**  
P.O. Box 283  
Gorham, NH 03581-0283